

DocumentViewer_v3

WIREFRAMES

DESKTOP & TABLET

VERSION 2.3

PUBLISHED Thu Feb 26 2015

AUTHORS Columbus,Tom

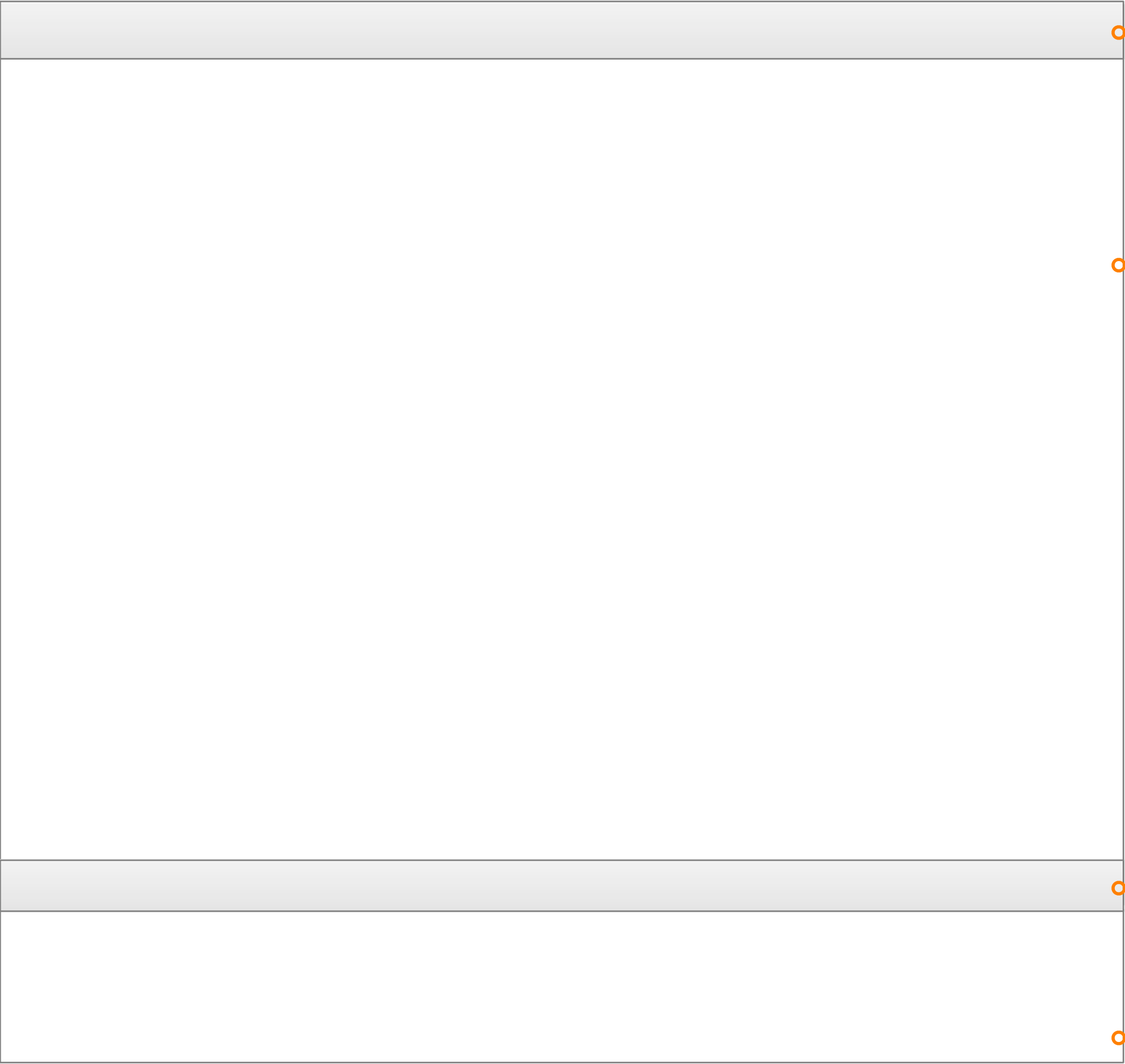

Tool Bar

36px tall by X wide.
The width should adjust according to available screen real-estate

Node in Focus Display

Height and width should adjust according to available screen real-estate

Actions Bar

32px tall by X wide.
The width should adjust according to available screen real-estate

Task in Focus Display

X tall by X wide
**See Task in Focus Section for further description*
The height should accommodate the description text + 16px space at the bottom
The width should adjust according to available screen real-estate

Task In Focus - Min/Max

Task in Focus Maximized

▼ TASK DESCRIPTION

Lorem Ipsum is simply dummy text of the printing and typesetting industry. Lorem Ipsum has been the industry's standard dummy text ever since the 1500s, when an unknown printer took a galley of type and scrambled it to make a type specimen book. It has survived not only five centuries.

FLOW: Endorsement
STEP: Sign documents and...
POLICY: #6250-343
ASSIGNED TO: Mike Mann
FROM: Bill Roberts

⋮

Task in Focus Minimized

▶ TASK DESCRIPTION

⋮

Task in Focus Dismissed (no Task in Focus)

***Minimizing, maximizing and dismissing a task should all have animated transition up or down respectively. The animation should have an ease in/out effect and last for 500ms**

Task In Focus - Construction & Click Targets

24px 16px 8px

MAXIMIZED TASK

Task in Focus's height is determined by the height needed to display the entire description or details without scrolling plus 16px padding at the base
See Example A

Task Description gets 65% of available screen width or whatever % is remaining after Task Details are displayed

Task Details occupy a minimum of 25% of the available screen width & max out at 35% of available screen width. The width can vary between those percentages as needed
See Example A

Ellipse area (if needed)
When an ellipse is used a tooltip should be available to display any truncated text

▼ TASK DESCRIPTION
Lorem Ipsum is simply dummy text of the printing and typesetting industry. Lorem Ipsum has been the industry's standard dummy text ever since the 1500s, when an unknown printer took a galley of type and scrambled it to make a type specimen book. It has survived not only five centuries, but also the leap into electronic typesetting, remaining essentially unchanged.

Task Details Area
FLOW: Endorsement
STEP: Sign documents and...
POLICY: #6250-343
ASSIGNED TO: Mike Mann
FROM: Bill Roberts
⋮

MAXIMIZED TASK - Click Targets

Minimizes task description

Brings focus to the document associated with the Task. Focus applies to both the viewer and the file tree

Displays actions menu

▼ TASK DESCRIPTION
Lorem Ipsum is simply dummy text of the printing and typesetting industry. Lorem Ipsum has been the industry's standard dummy text ever since the 1500s, when an unknown printer took a galley of type and scrambled it to make a type specimen book. It has survived not only five centuries, but also the leap into electronic typesetting, remaining essentially unchanged.

FLOW: Endorsement
STEP: Sign documents and...
POLICY: #6250-343
ASSIGNED TO: Mike Mann
FROM: Bill Roberts
⋮

MINIMIZED TASK

▶ TASK DESCRIPTION ⋮

MINIMIZED TASK - Click Targets

Maximizes task description

Brings focus to the document associated with the Task. Focus applies to both the viewer and the file tree

Displays actions menu

▶ TASK DESCRIPTION

⋮

Example A

65% 35%

%

▼ TASK DESCRIPTION
████████████████████
████████████████████
████████████████████
████████████████████

████████████████████
████████████████████
████████████████████
████████████████████
⋮

*MAXIMUM TASK DETAIL ALLOWED

75% 25%

%

▼ TASK DESCRIPTION
████████████████████
████████████████████
████████████████████

████████████████████
████████████████████
████████████████████
⋮

*MINIMUM TASK DETAIL NEEDED

File & Folder Node Viewer Construction

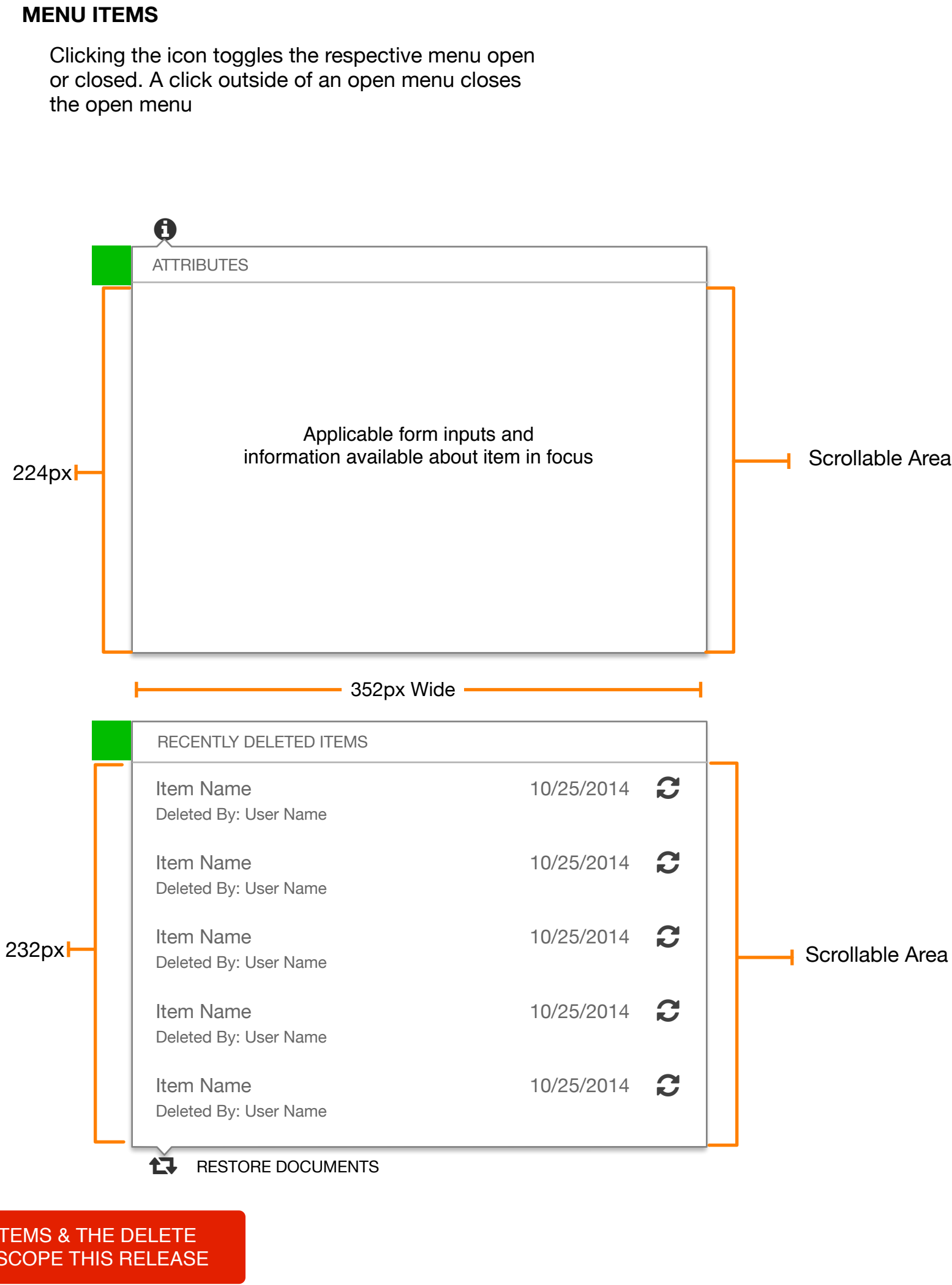
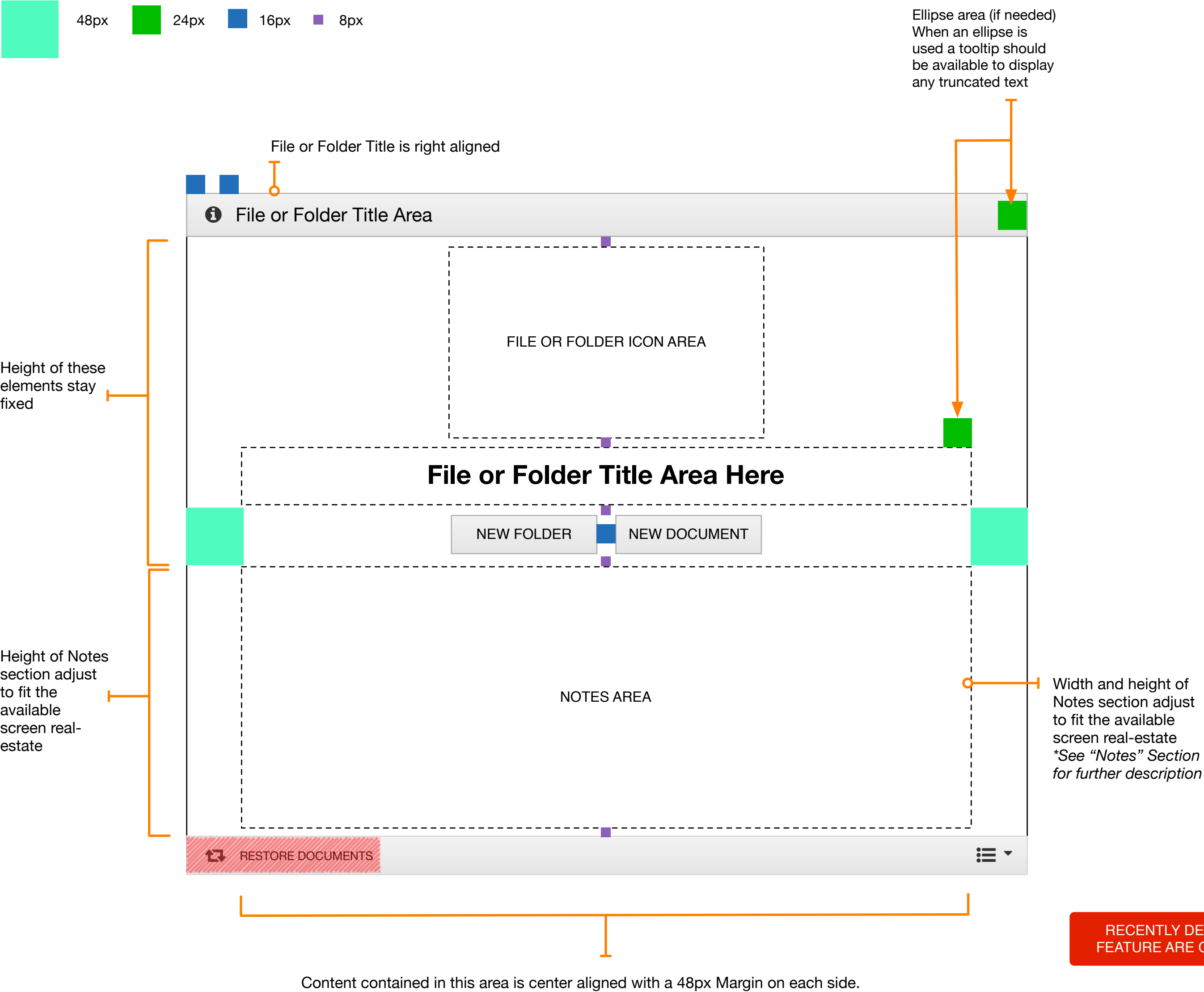

File & Folder Node ClickTargets & Keyboard Interactions

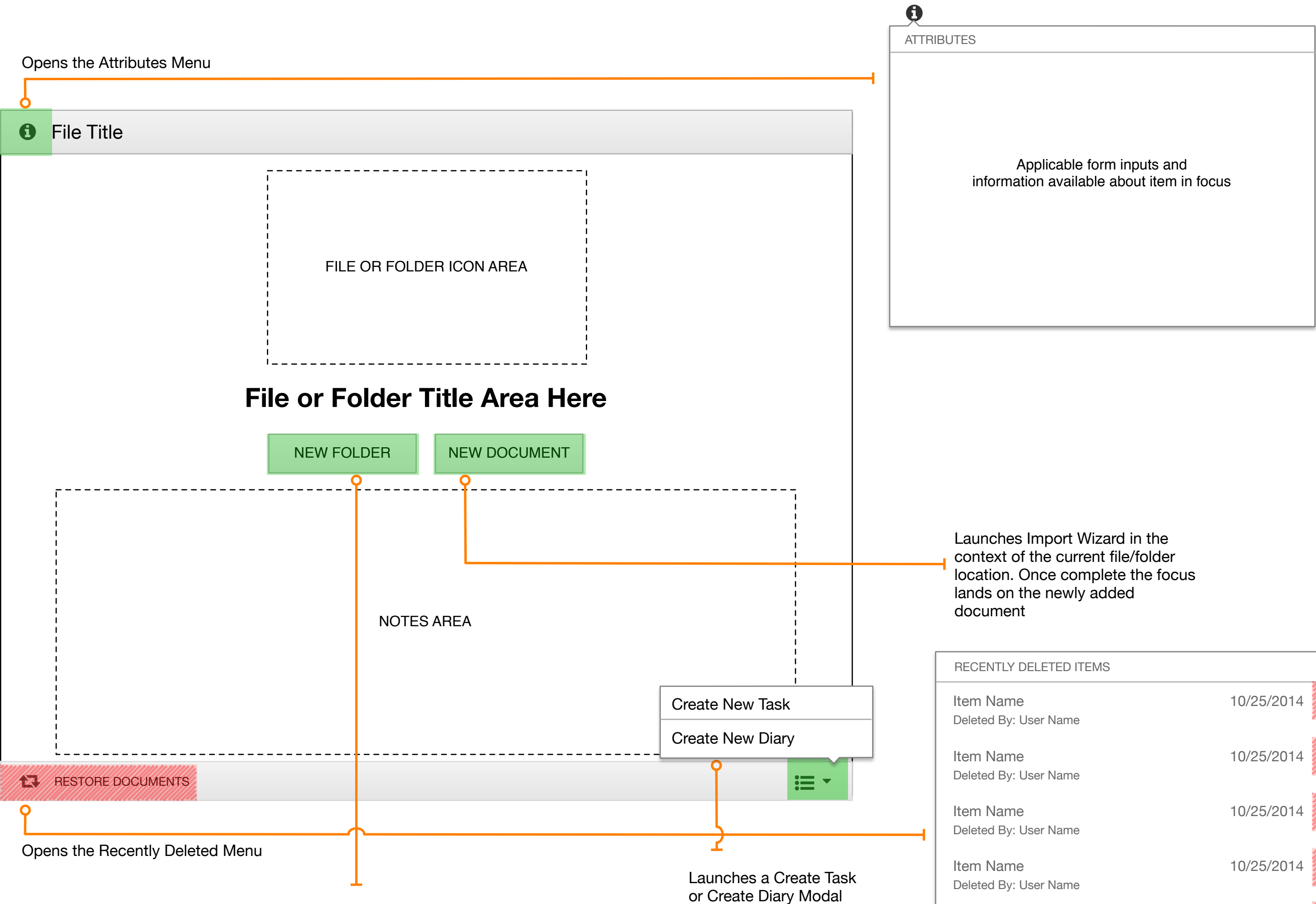

ATTRIBUTES

Applicable form inputs and information available about item in focus

Keyboard Interactions

Ctrl + I Show/Hide Attributes

Ctrl + N Add Note

Ctrl + D New Document

Ctrl + F New Folder

Ctrl + R Restore Documents

DELETE

RECENTLY DELETED ITEMS

Item Name Deleted By: User Name	10/25/2014	
Item Name Deleted By: User Name	10/25/2014	
Item Name Deleted By: User Name	10/25/2014	
Item Name Deleted By: User Name	10/25/2014	
Item Name Deleted By: User Name	10/25/2014	

RESTORE DOCUMENTS

Launches a confirmation Modal to confirm the user's intent to restore the document or folder

RECENTLY DELETED ITEMS & THE DELETE FEATURE ARE OUT OF SCOPE THIS RELEASE

Launches an Input based Modal to create and name a Folder in the context of the current file/folder location. Once complete the focus lands on the newly created Folder.



File & Folder Notes Anatomy & Construction

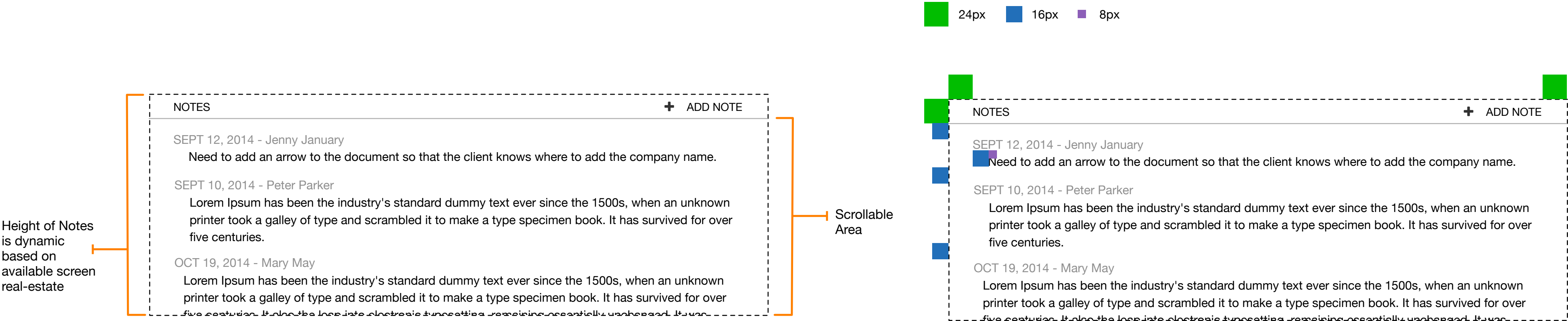

CLICK TARGET

Launches a modal to capture input text

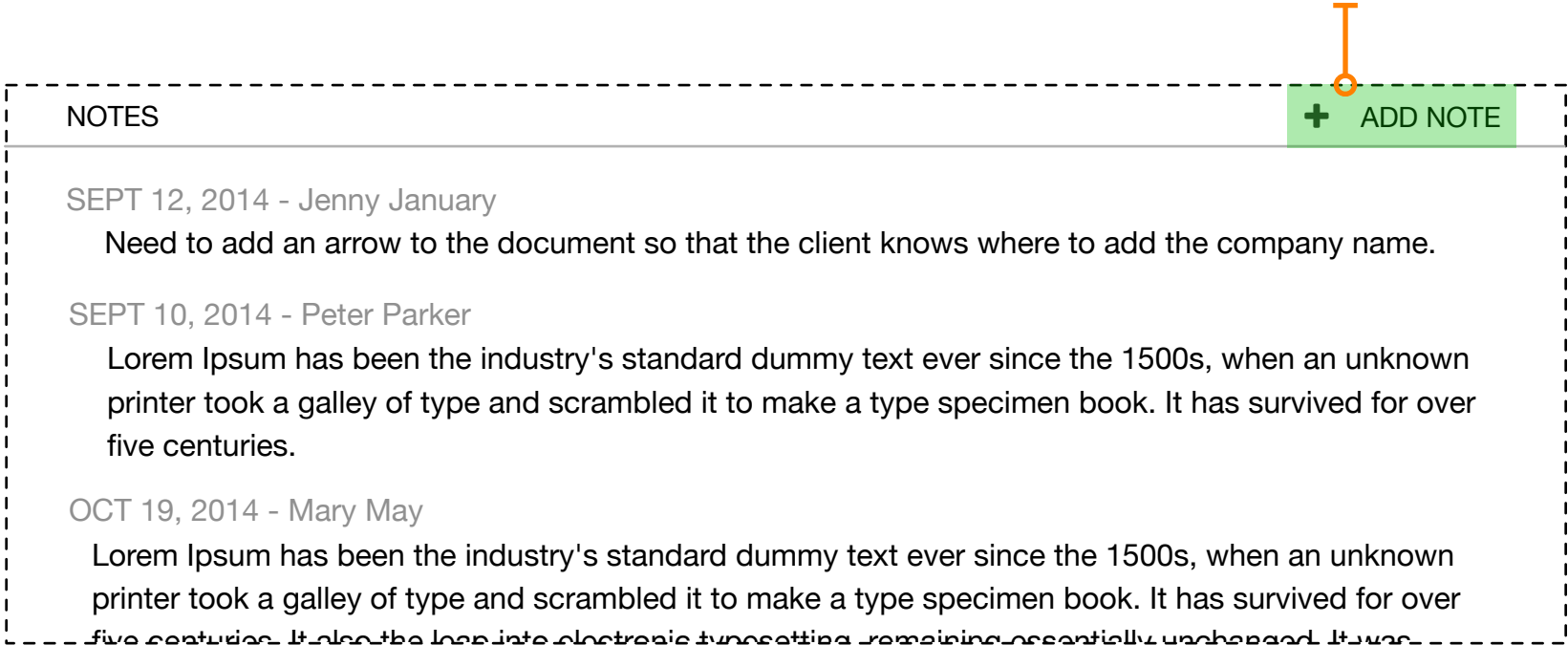

ADD NOTE SEQUENCE

*All animations should have an ease in and ease out

User selects "ADD NOTE"

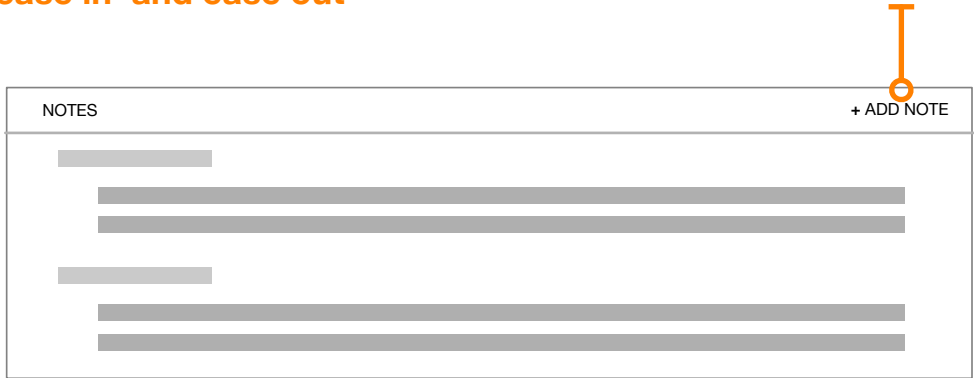

Modal fades in 300ms

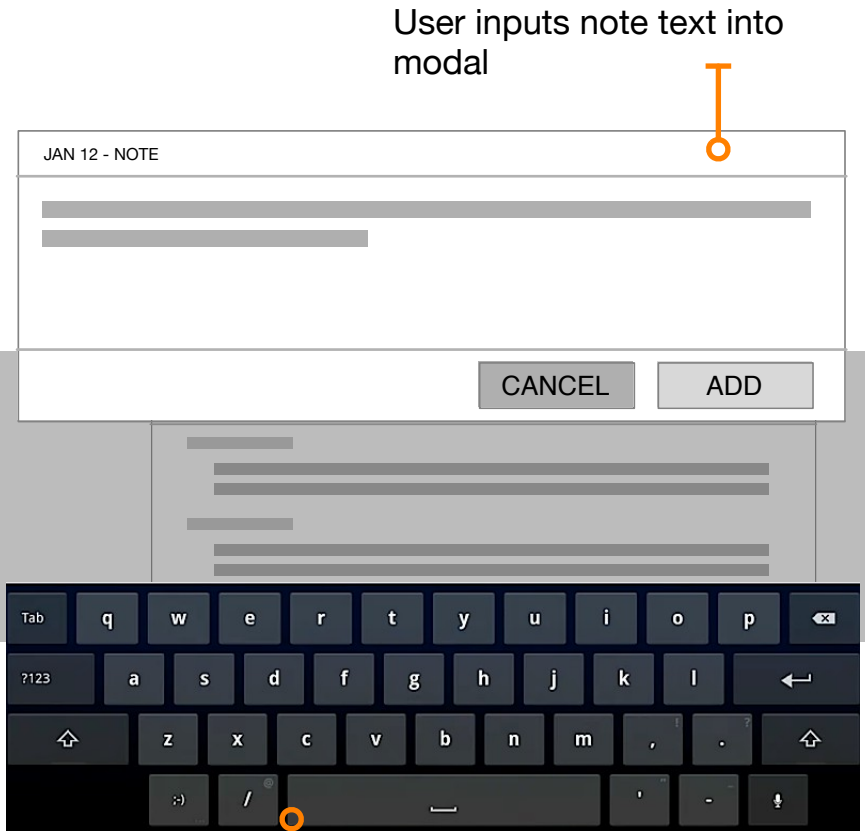

Modal fades out 300ms

New note slides down from under the Note Menu 500ms

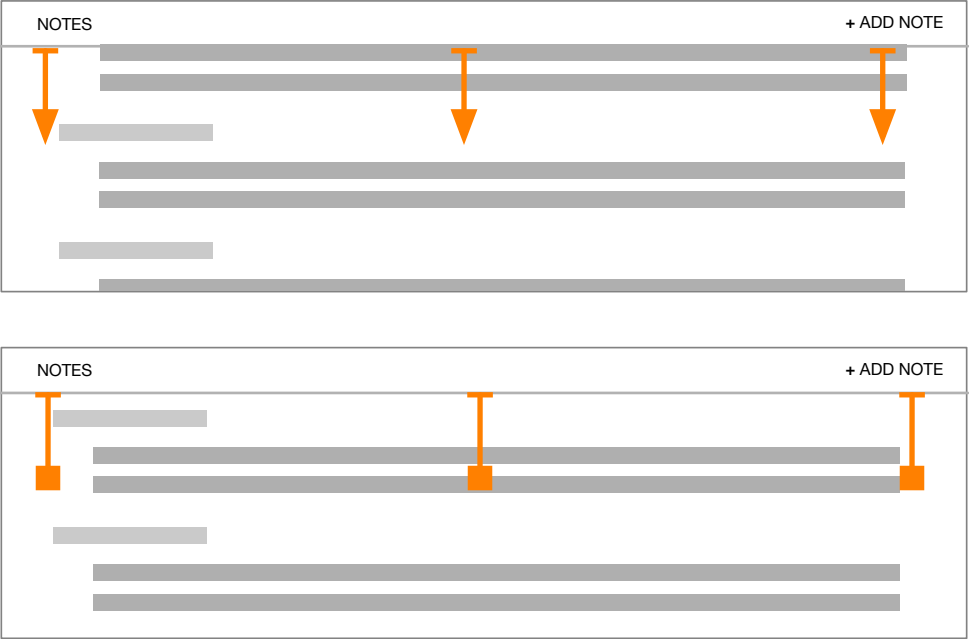

Document Node Anatomy & Construction

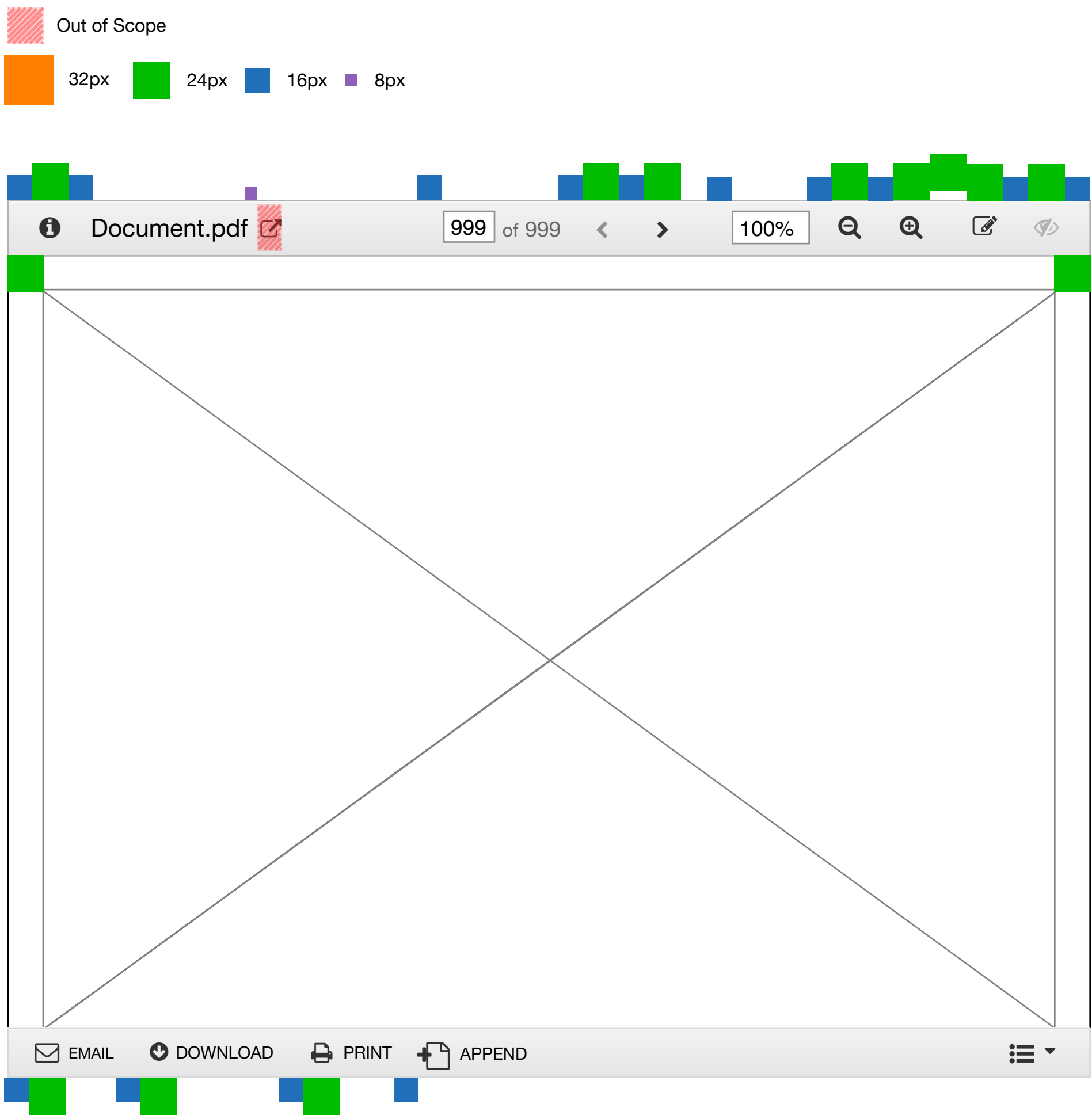
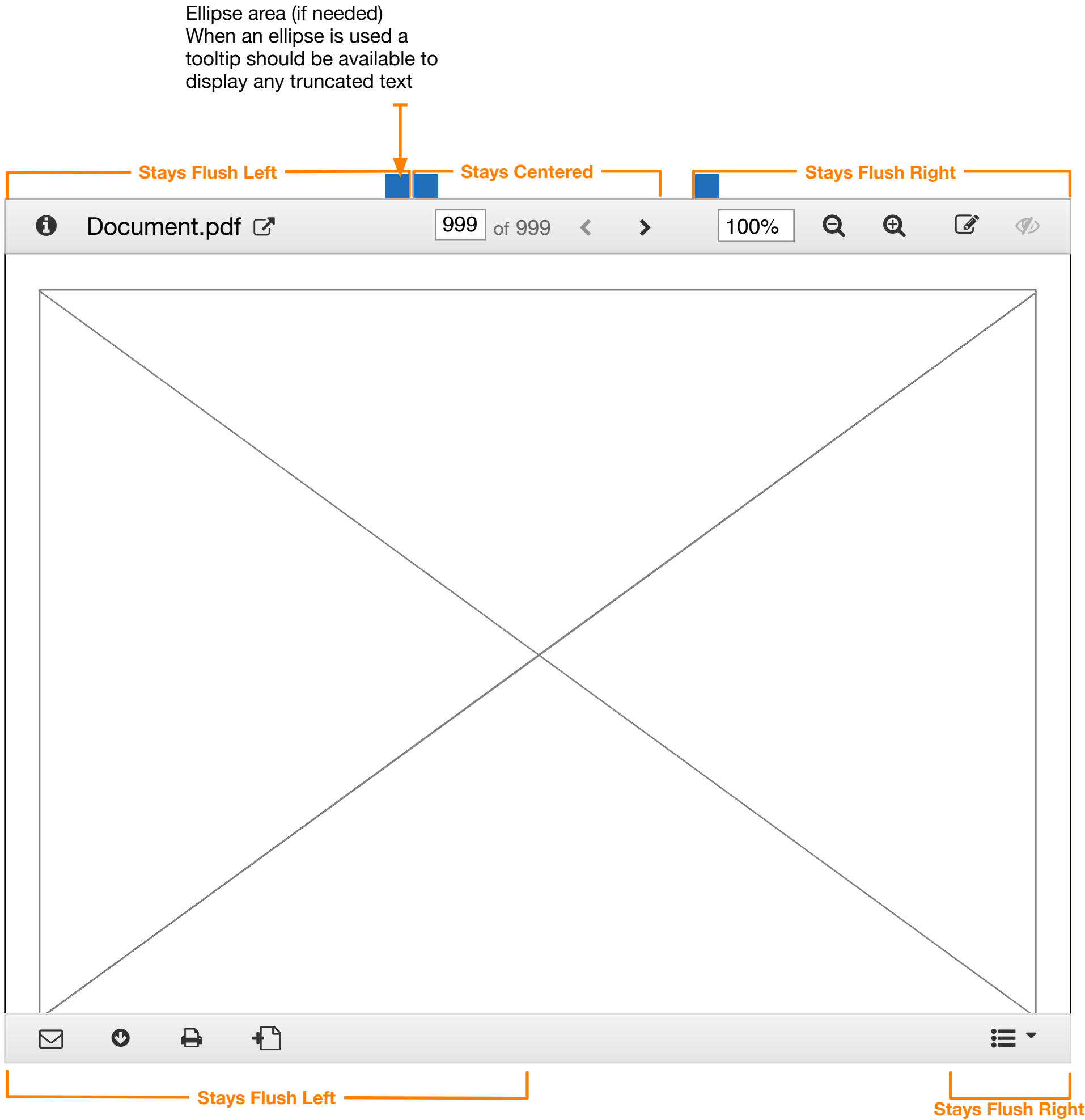

Document Page Node Click Targets

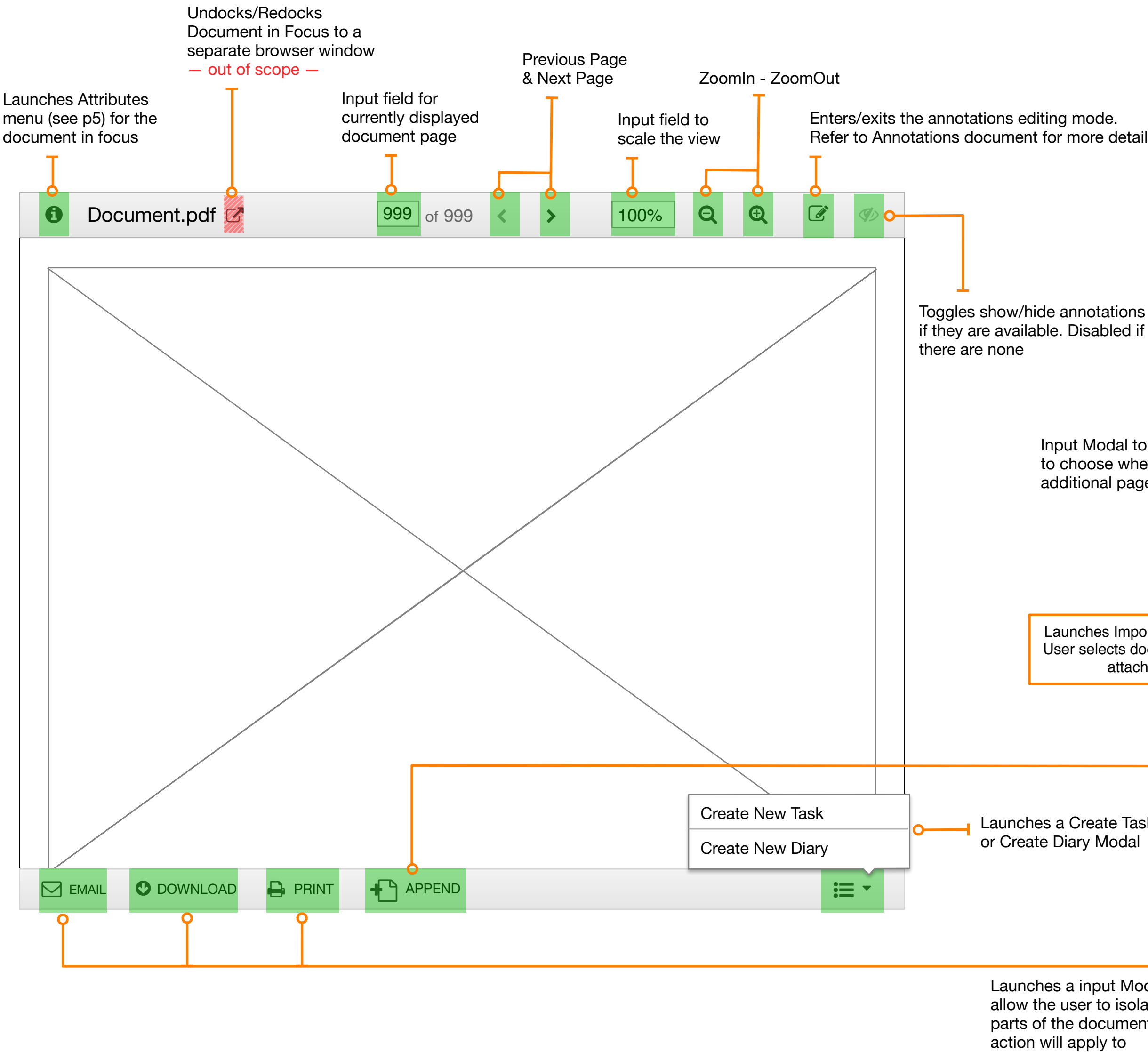

Append Document

Select where to add addition pages to this document

☒ Beginning of the document

☐ End of the document

CANCEL

APPEND TO BEGINNING

Referring Action (ex: Download)

Select the pages and features you would like to include

☒ Entire Document 56p - 5.6MB

☐ Specific Pages

ex: 1, 5, 10-15, 37, 55

☒ With Annotations

CANCEL

NEXT

Document Node Presentation & Manipulation

Upon entering a document, the image should be presented at 100% of the available width. The document can scroll under the toolbar but initially is positioned with a 24px padding between the top of the document and the tool bar. If possible include a 24px padding on the right and left of the document. The user can scroll, drag, or use directional keys to view the rest of the document.

The goal being to show as much of the document at a readable size as possible initially vs showing more of a thumbnail version that is unreadable.

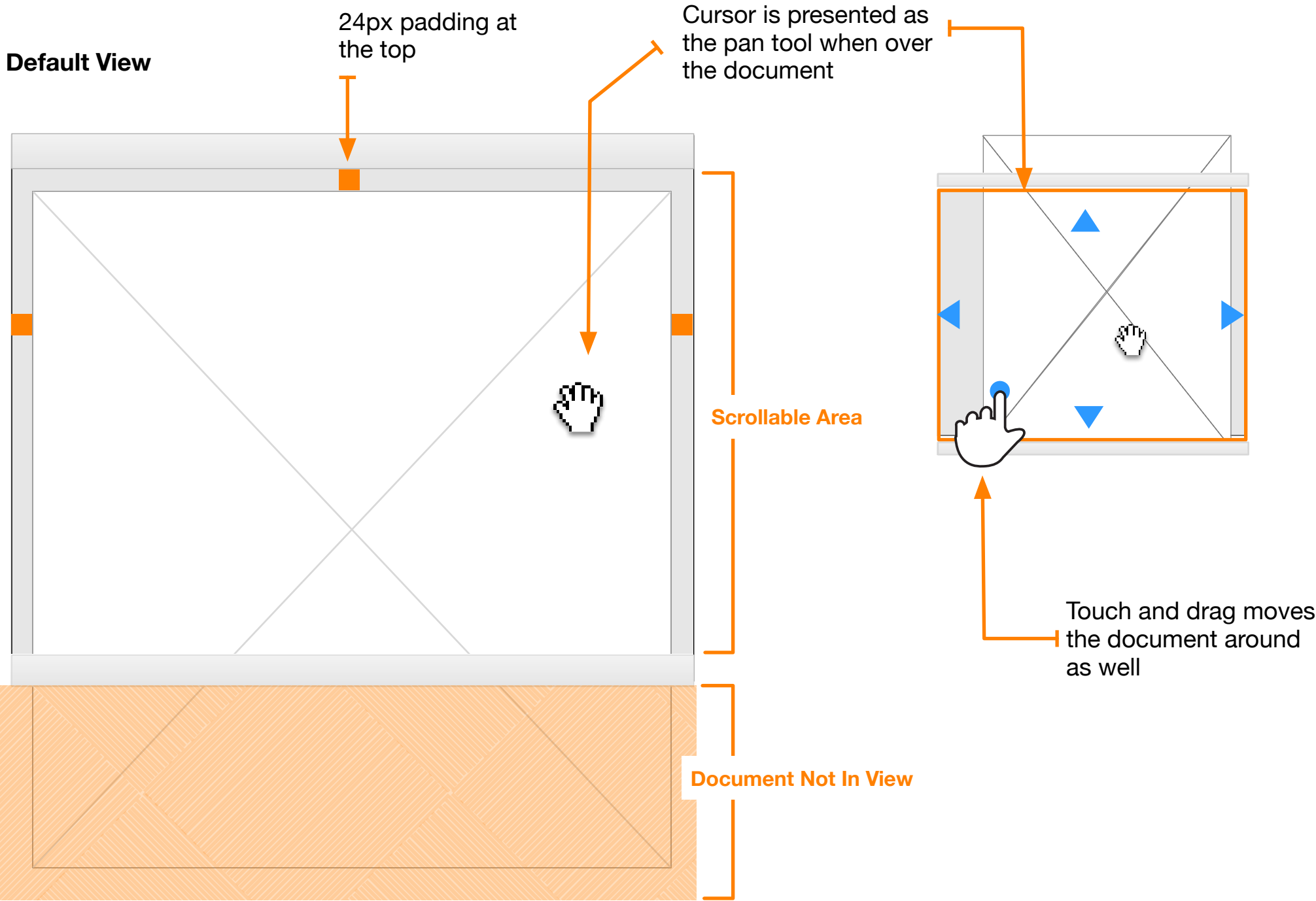

EXAMPLE 1

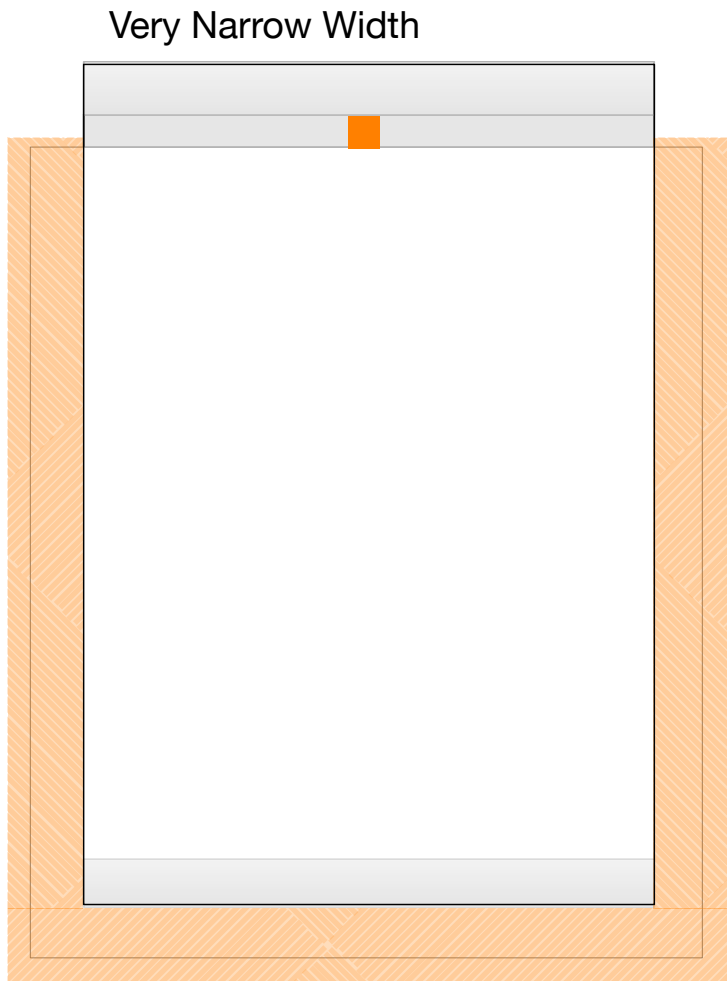

EXAMPLE 2

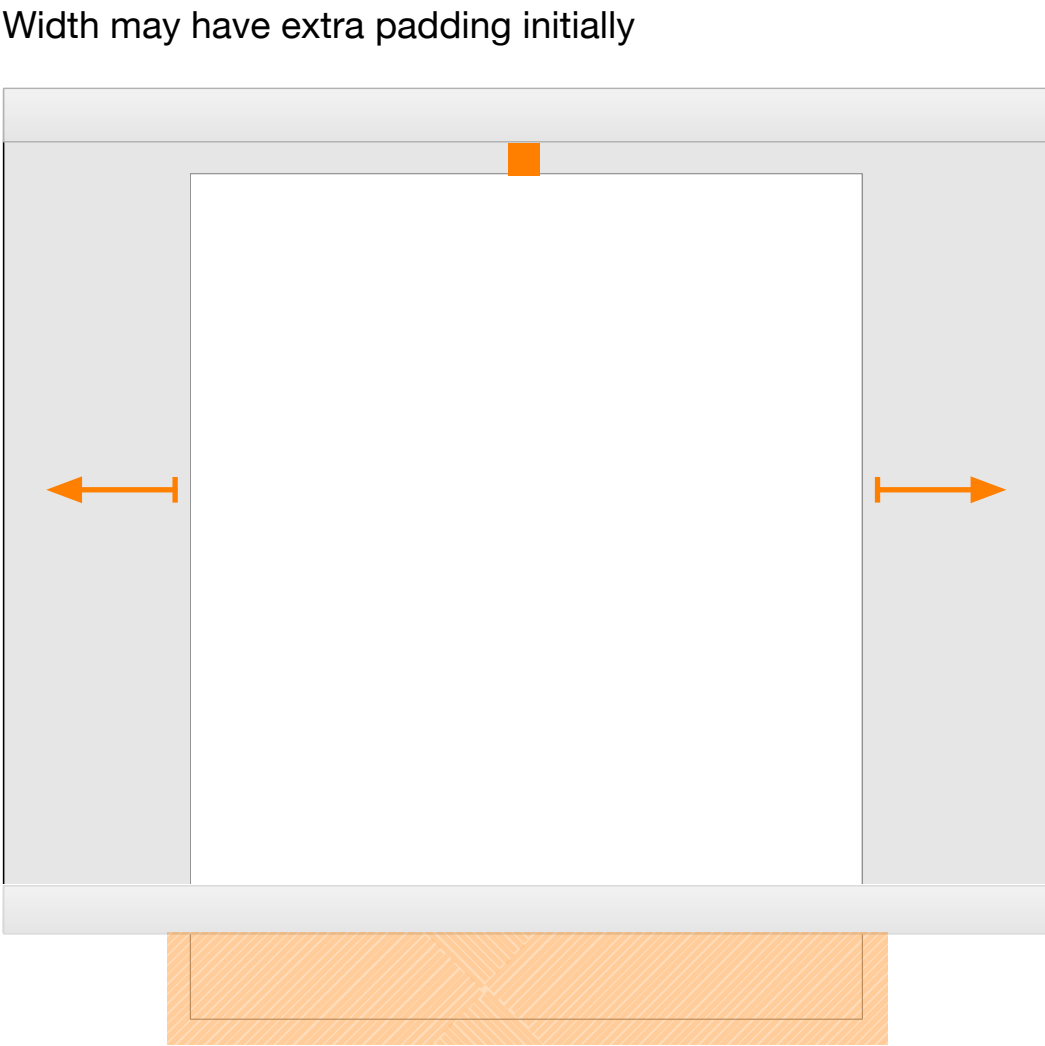

EXAMPLE 3

Rare case where a document fits 100% within the entire screen

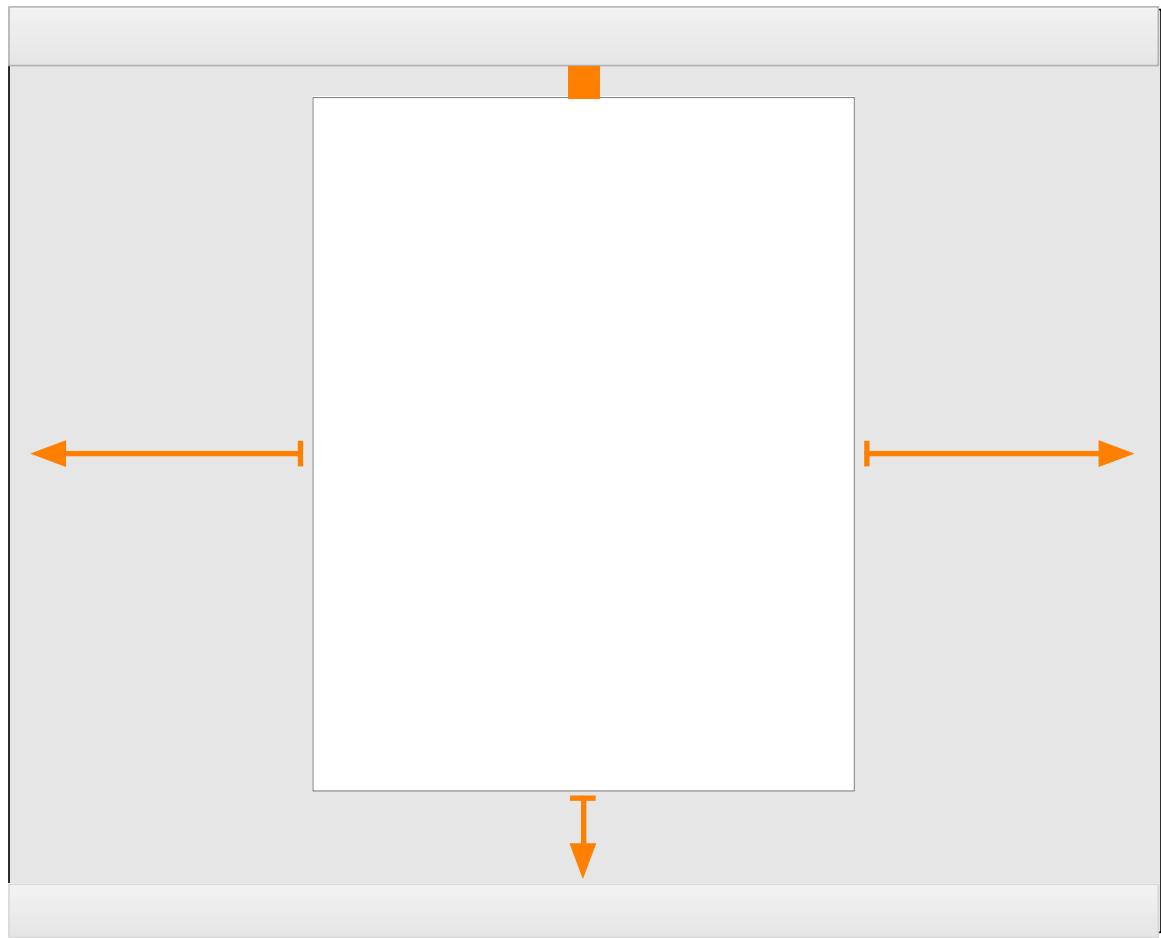

Document Node Keyboard Interactions & Gestures

KEYBOARD INTERACTIONS

Ctrl

+

+

=

Zoom In

Ctrl

+

-

=

Zoom Out

Ctrl

+

{

[

Enter/Exit Annotation Mode

Ctrl

+

}

]

Show/Hide Annotations

Ctrl

+

W

Download

Ctrl

+

E

Email

Ctrl

+

P

Print

Ctrl

+

I

Show/Hide Attributes

Ctrl

+

>

.

Puts focus on page input field

Ctrl

+

!

1

Closes the file in focus

Ctrl

+

|

\

Dock/Undock

Y

 of 999

Move document 50px left

◀

▲

Move document 50px up

▼

Move document 50px down

▶

Move document 50px right

First Page of document

home

page up

Previous Page

Last Page of document

end

page down

Next Page

TOUCH GESTURES

Pinch

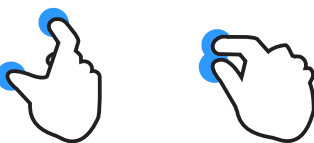

= Zoom Out

Spread

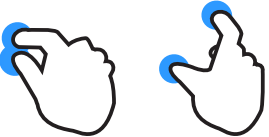

= Zoom In

Double Tap



= Reset Zoom to 100%

Touch and Drag

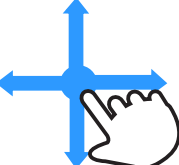

= Move document in direction of the drag

Swipe Left



= Next Page

Two Finger Swipe Left



= Last Page of Document

Swipe Right



= Previous Page

Two Finger Swipe Right



= First Page of Document

Multi-Touch Rotate Clockwise

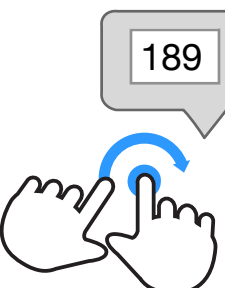

= Scroll Pages of Document Forward

Multi-Touch Rotate Counter Clockwise



= Scroll Pages of Document Backward

MultiFrame Page of Document Construction

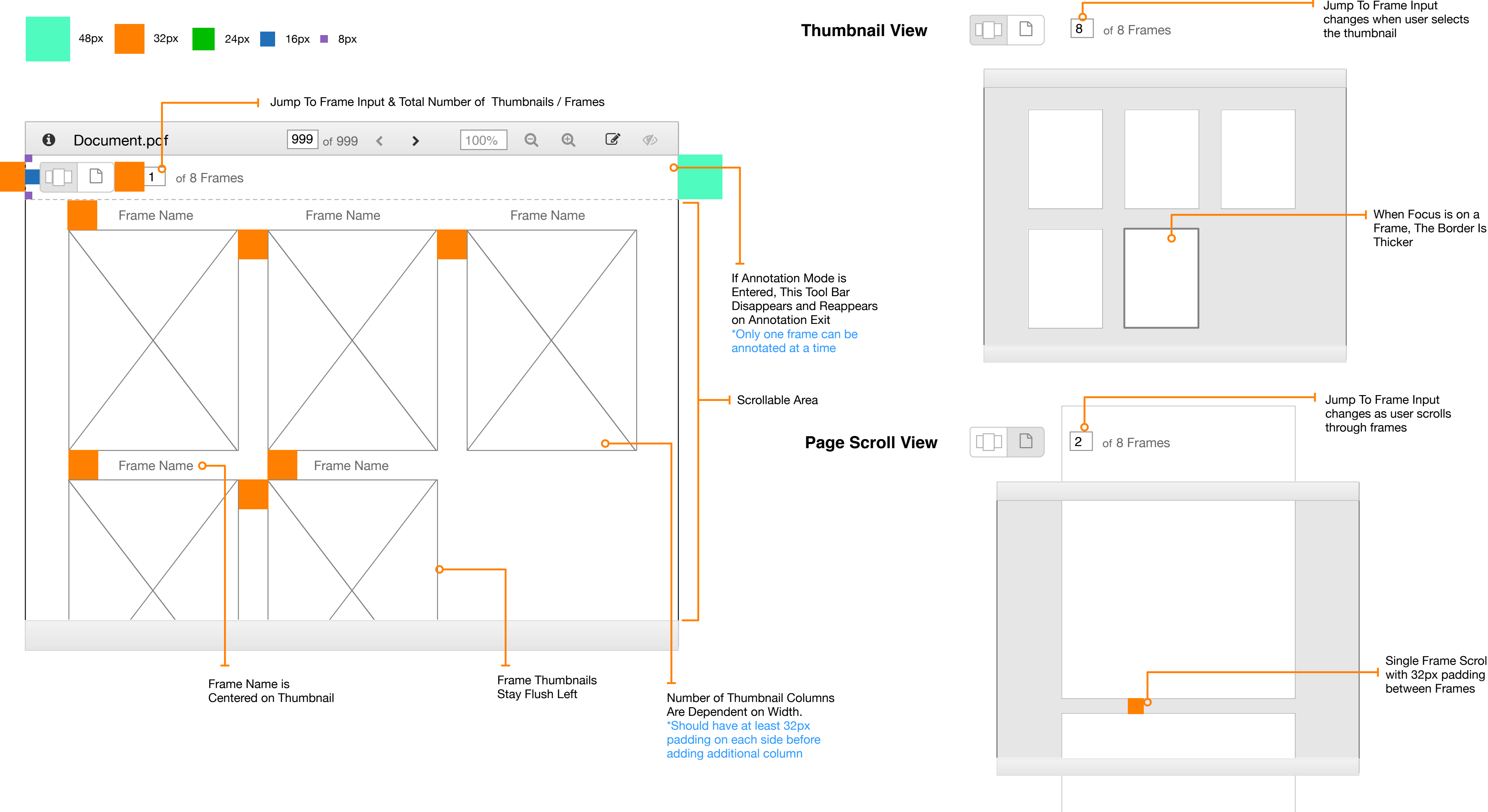

MultiFrame Page of Document Navigation

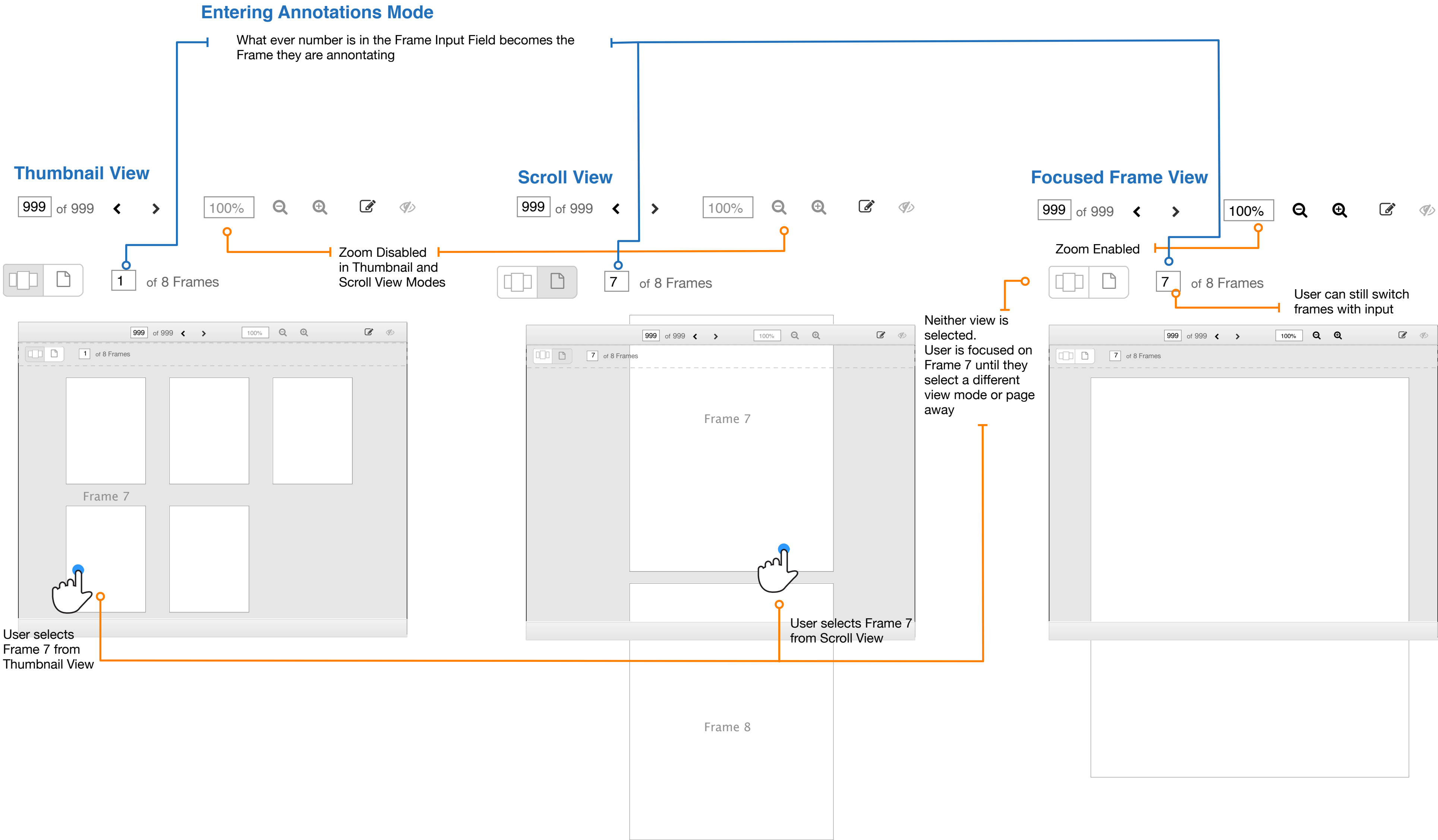

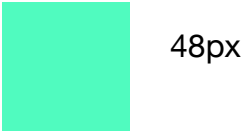

When Historical Notes are selected in the tree

Historical Notes

Folder Name

Folder Name

Folder Name

Folder Name

Document Name

Document Name

Title of Notes

NOTES AREA

Top of Notes

Scrollable